

WYRE FOREST DISTRICT COUNCIL
THE WYRE FOREST DISTRICT COUNCIL (OFF STREET PARKING PLACES)
ORDER 2015 (2) - NOTICE OF PROPOSALS

Notice is hereby given that the Wyre Forest District Council ("the Council") in exercise of its powers under Section 32 of the Road Traffic Regulation Act 1984 and of all other enabling powers proposes to make the above Order. The variation from the current off street parking places order relates only to the provision of parking at the **Aldi Store and Pike Mills Surface Vehicle Parks, Kidderminster**. The Order will come into effect on such date that the Solicitor of the Council is satisfied that the following conditions have been met:

- a. That the s106 Agreement dated 5th May 1992 between Wyre Forest District Council and Aldi Stores Limited has been varied to reflect the extension to the Aldi store and the reduction in the number of parking spaces set out in this Notice; and
- b. That planning permission for the store extension has been granted.

The effect of the Order will be as follows:

1. Revoking all previous off-street car parking orders on the date that the new Order comes into effect.
2. Reducing the area of the Aldi Store Surface Vehicle Park by 19 spaces and removing 2 spaces from the Pike Mills Surface Vehicle Park.

A copy of the Order, plans showing the land affected and a statement of the Council's reasons for making the Order can be inspected between 09:00 and 16:30 Monday to Friday at Wyre Forest House, Kidderminster and the Worcestershire Hub, Town Hall, Kidderminster and on the Council's website. If you wish to object to this Order, the objection together with the grounds for making it must be made in writing to the Solicitor of the Council, Wyre Forest District Council, Wyre Forest House, Finepoint Way, Kidderminster, DY11 7WF **not later than 8th May 2015.**

Dated the 16th April 2015

**ROAD TRAFFIC REGULATION ACT 1984
THE WYRE FOREST DISTRICT COUNCIL (OFF-STREET PARKING PLACES)
ORDER 2015**

Statement of Reasons

1. In accordance with the decision of the Strong Leader dated 12th March 2015 and subject to paragraph 2 below, Wyre Forest District Council is proposing to amend the Off Street Parking Places Order 2015 to vary the number of spaces at the Aldi Store Surface Vehicle Park and Pike Mills Surface Vehicle Park.
2. There is currently a S106 Agreement in place between Wyre Forest District Council and Aldi Stores Ltd which allows for 62 parking spaces within the ownership of Aldi to be maintained and operated by the Council. Aldi are proposing to extend their store, which will reduce the parking spaces in the Aldi car park by 19 and will also reduce the number of spaces in the Pike Mills car park by 2 to enable access to the store. Aldi have agreed to make a one-off payment to the Council to compensate for the loss of income from these parking spaces.
3. The Council does not believe that the reduction in spaces will cause a shortage of parking spaces.
4. The Council shall only make the Order, and the reduction will therefore only take effect, if agreement is reached to amend the existing s106 agreement and if planning permission for the store extension is granted.
5. The attached plans show the current and proposed store and car park. Feasibility number 05 shows the existing layout and feasibility number 07 shows the proposed layout. Two further plans are attached which show the current boundary of the car park and the proposed boundary, these plans will be included in the amended order.

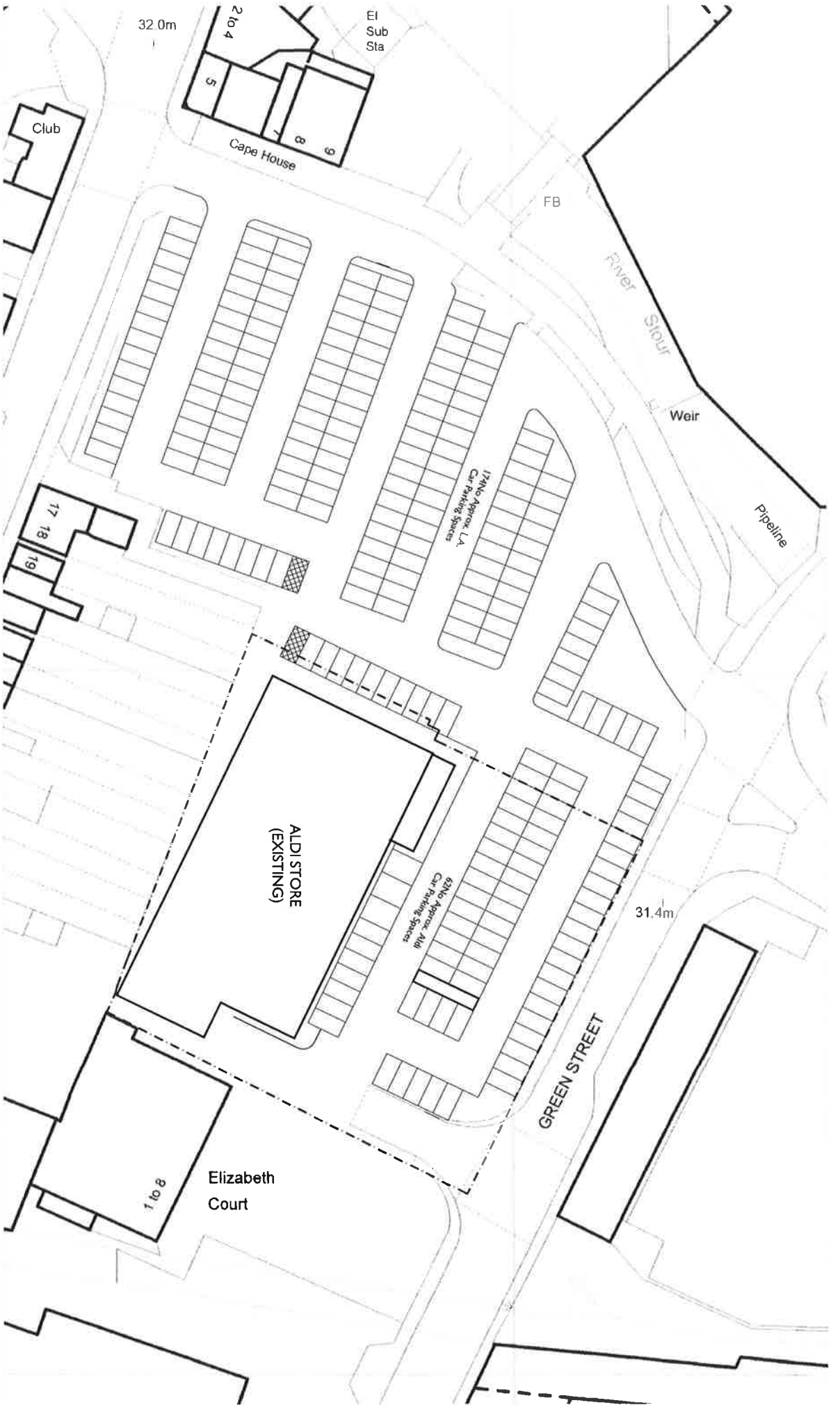

DALKIN SCOTTON PARTNERSHIP
ARCHITECTS LIMITED

303 FORT DUNLOP ROAD PARKWAY BIRMINGHAM B24 9DT

TEL: 0121 347 1848 FAX: 0121 347 1844 www.dskparchitects.com

CLIENT **ALDI STORES LIMITED**

PROJECT **GREEN STREET, KIDDERMINSTER**

TITLE **EXISTING SITE LAYOUT**



SCALE **1:500 @ A3** DRAWN **NSH**

DATE **25-07-2011** CHECKED

DWG No. **Y11A06 - EXTG - 05**



ALL DIMENSIONS TO BE VERIFIED ON SITE PRIOR TO ANY WORK. ALL SITE WORKS BEING COMMENCED. ALL DIMENSIONS TO BE REPORTED TO DALKIN SCOTTON PARTNERSHIP ARCHITECTS LIMITED BEFORE ANY WORK IS PUT IN HAND. DO NOT SCALE FROM THIS DRAWING. THIS DRAWING IS TO BE READ IN CONJUNCTION WITH RELEVANT CONSULTANTS' AND REGULATORY DRAWINGS. THIS DRAWING IS THE PROPERTY OF DALKIN SCOTTON PARTNERSHIP ARCHITECTS LIMITED. COPYRIGHT IS RESERVED BY THEM AND THE DRAWING IS VALID ON THE CONDITION THAT IT IS NOT COPIED, REPRODUCED, RETAINED OR DISCLOSED TO ANY UNAUTHORISED PERSON WHOLLY OR IN PART WITHOUT THE WRITTEN CONSENT OF DALKIN SCOTTON PARTNERSHIP ARCHITECTS LIMITED.

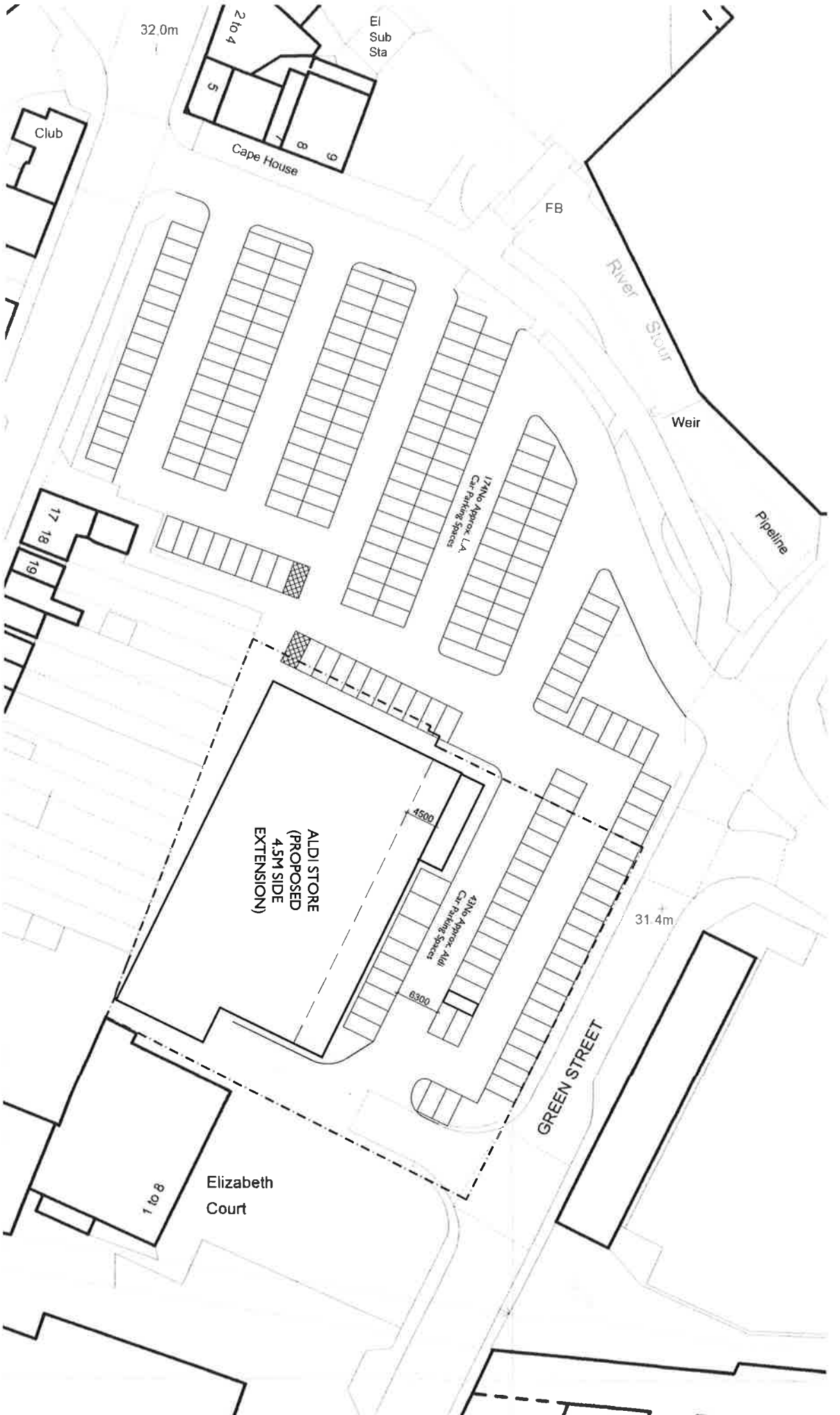

DALKIN SCOTTON PARTNERSHIP
ARCHITECTS LIMITED
105 FORT DUNLOP FORT PARK WATERBURY HUNTS CROSS
TEL: 0121 727 1943 FAX: 0121 727 1944 WWW.DSKA.CO.UK

CLIENT **ALDI STORES LIMITED**
PROJECT **GREEN STREET, KIDDERMINSTER**
TITLE **FEASIBILITY 07**



SCALE **1:500 @ A3** DRAWN **NSH** NORTH
DATE **14-03-2014** CHECKED
DWG No. **Y11A06 - FEAS - 07** REV

ALL DIMENSIONS TO BE GIVEN ON SITE FROM TO ANY SIGN ON SITE WORKING BEING COMPLETED. ANY DIMENSIONS TO BE REPORTED TO DALKIN SCOTTON PARTNERSHIP ARCHITECTS LIMITED SHOULD ANY WORK BE NOT IN HAND. DO NOT SCALE FROM THIS DRAWING. THIS DRAWING IS TO BE READ IN CONJUNCTION WITH RELEVANT CONSULTANTS AND SPECIALIST DRAWINGS. THE DRAWING IS THE PROPERTY OF DALKIN SCOTTON PARTNERSHIP ARCHITECTS LIMITED. PERMISSION IS GRANTED BY THEM AND THE DRAWING IS ISSUED ON THE CONDITION THAT IT IS NOT COPIED, REPRODUCED, RETURNED OR DISCLOSED TO ANY UNAUTHORISED PERSON EITHER WHOLLY OR IN PART WITHOUT THE WRITTEN CONSENT OF DALKIN SCOTTON PARTNERSHIP ARCHITECTS LIMITED.

Date:- 27 July 2010

OS sheet:- SO8376SW

Scale:- 1:1250

Based upon the Ordnance Survey mapping with the permission of the Controller of Her Majesty's Stationery Office Crown copyright (C).
Unauthorised reproduction infringes Crown Copyright and may lead to prosecution or civil proceedings. Licence number 100018317.

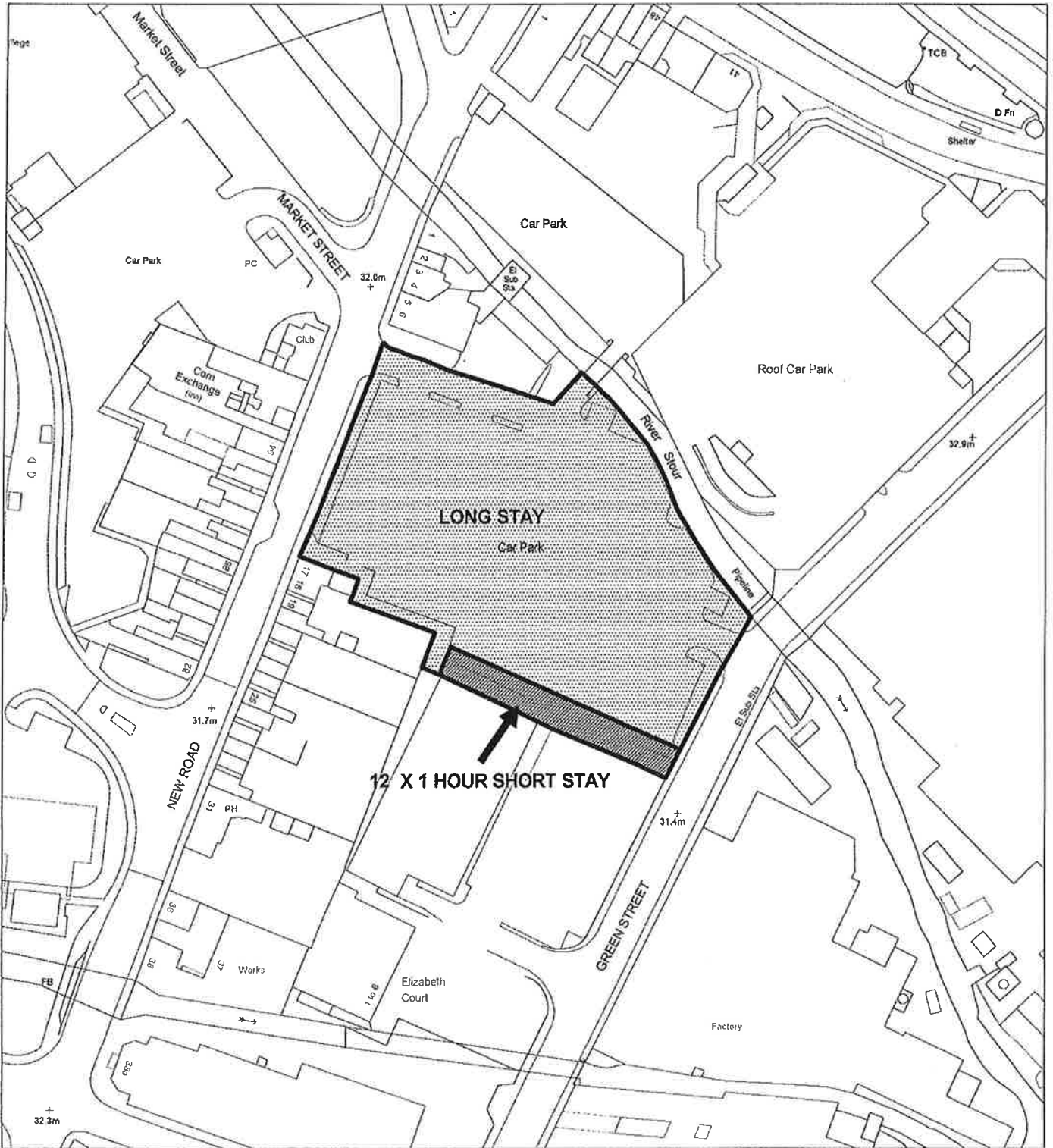

Wyre Forest District Council

PLANNING AND REGULATORY SERVICES DIRECTORATE

Location: Pike Mills Surface Car Park

Kidderminster

Drg. No. P.P.O.K8

Duke House, Clensmore Street, Kidderminster, Worcs. DY10 2JX. Telephone: 01562 732928. Fax: 01562 732556



Date:- 27 July 2010

OS sheet:- S08376SW

Scale:- 1:1250

Based upon the Ordnance Survey mapping with the permission of the Controller of Her Majesty's Stationery Office Crown copyright (C).

Unauthorised reproduction infringes Crown Copyright and may lead to prosecution or civil proceedings. Licence number 100018317.

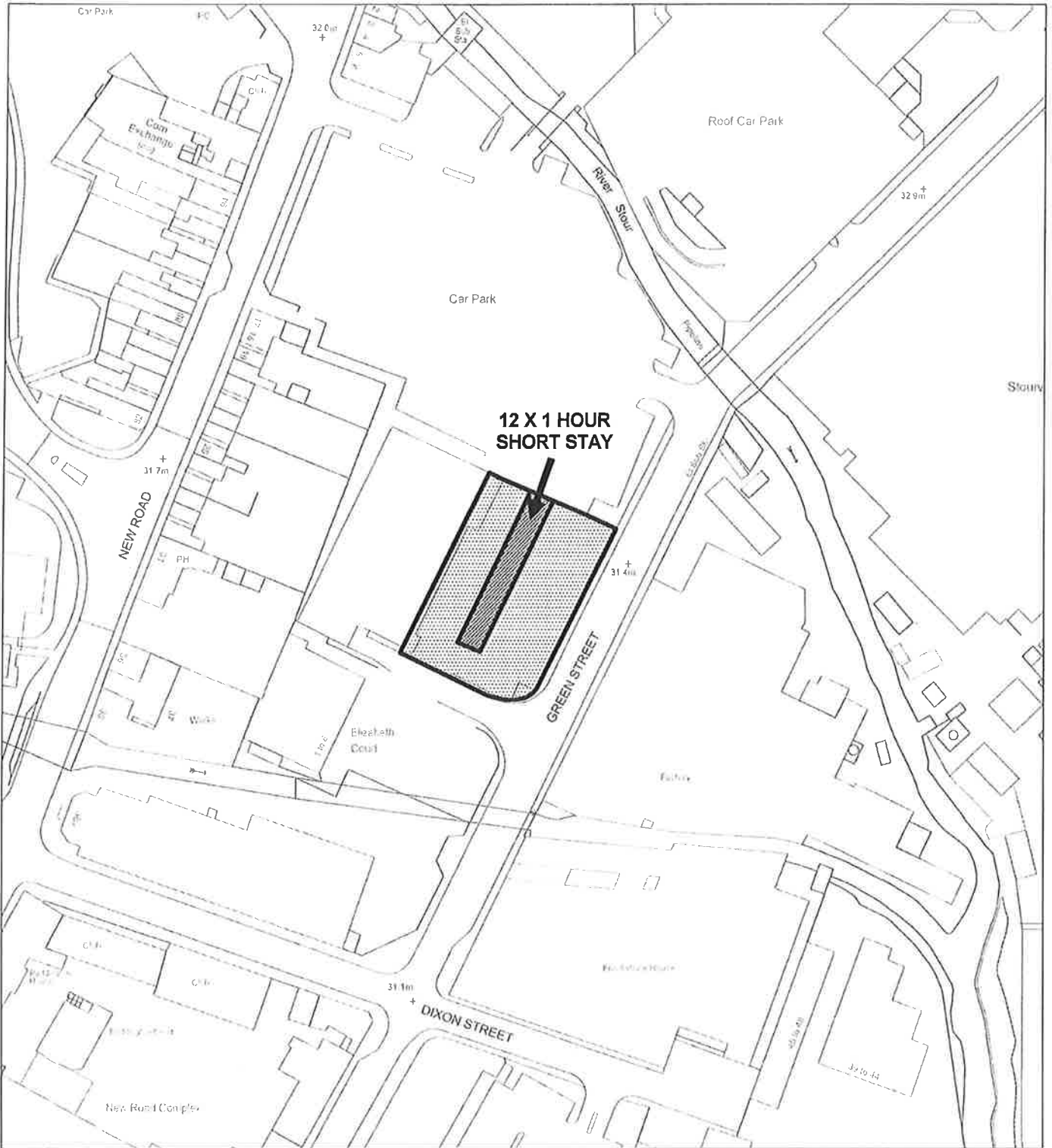

Wyre Forest District Council

PLANNING AND REGULATORY SERVICES DIRECTORATE

Location: Aldi Stores Surface Car Park

Kidderminster

Drg. No. P.P.O.K9

Duke House, Clensmore Street, Kidderminster, Worcs. DY10 2JX. Telephone: 01562 732928. Fax: 01562 732556



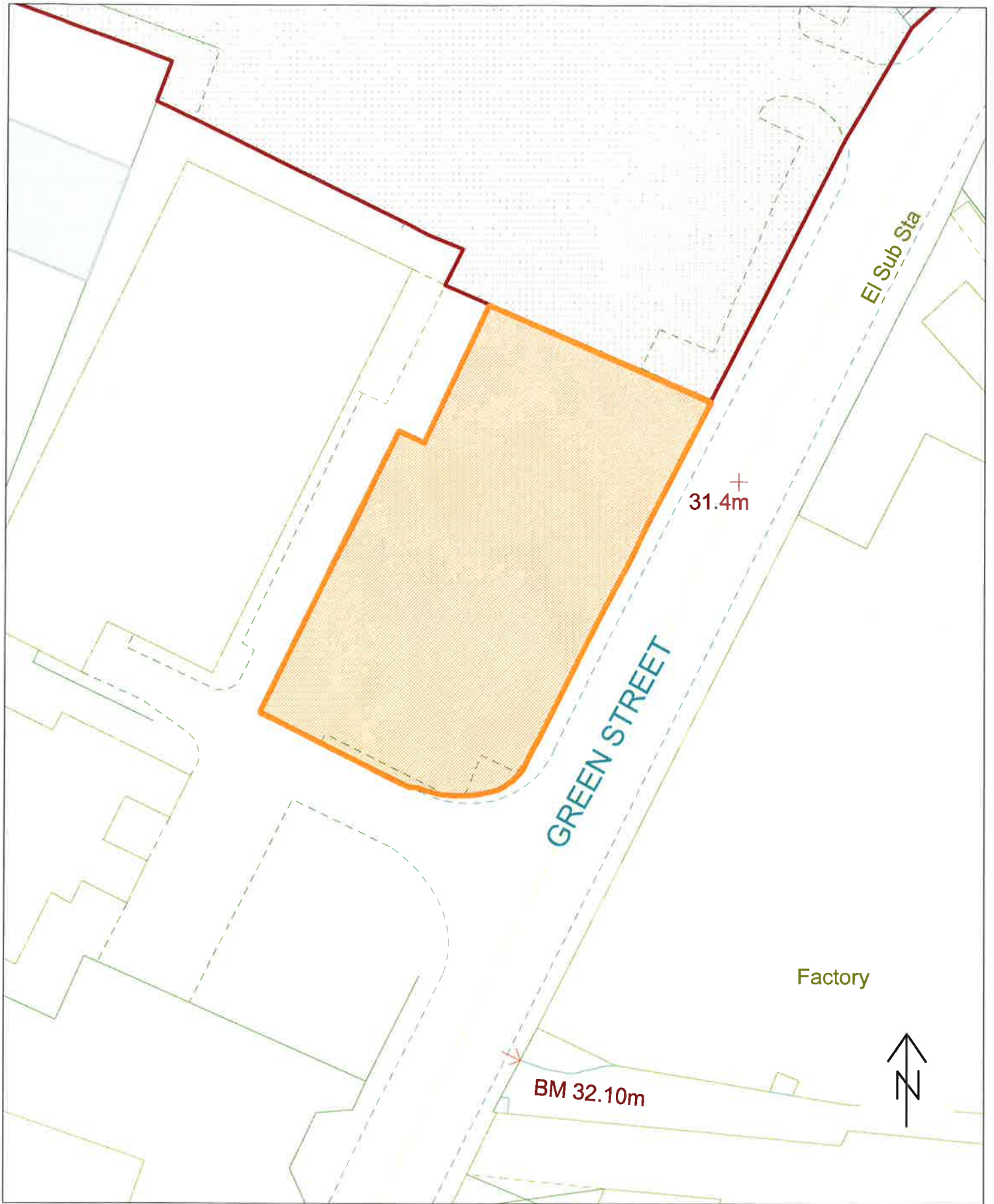

Wyre Forest District Council
Wyre Forest House
Finepoint Way
Kidderminster
DY11 7WF

WFDC Parking Places Order
Aldi Car Park
Green Street
Kidderminster

SO8376SW