



AIRBORNE FIBRE SAMPLING & ANALYSIS CERTIFICATE (Part 1)

Client: Wyre Forest District Council
 Report No: 1334
 Sample Date: 25/07/13

Address: WFOC, Wyre Forest House, Firepoint Way, Kidderminster
 Attention of: D. Edgerston
 Analysis Date: 25/07/13

Site Address: Laurence Leysing, Stowport Rd, DY11 2QE
 Field Bank: YES - 0273 - NOT RAN
 Issue Date: 25/07/13

Temperature (°C): 29
 Pressure (mbar): 1004
 Microscope Band Resolution: S
 Graticule Dia (µm): 100
 Timer S/N: 0163
 Tally Count S/Ns: 0977

Thermometer S/N: 0163
 Barometer S/N: 0387
 Stage Micrometer: 0348
 NPL Test Slide No: 0251
 Cal Due: 19-11-13
 Cal Due: 28-08-13
 Cal Due: 07-11-13

Cal Due: 19-11-13
 Cal Due: 28-08-13
 Cal Due: 07-11-13

Flow Rate Correction: 1
 Check Due: 19-11-13
 Microscope ID No: 0822
 Service Due: 16113

Sample No	Test Type	Location	Pump No	Cowl No.	Time		Indicated Flow Rate /pm		Intermediate Time	Flow	Volume (Litres)	Fibres	Fields	Calc' Result /ml	Reported Result /ml
					Start	Finish	Start	Mean							
001	B	BUS - PERIMETER DEPUT FENCE CAR PARK (A)	0656	0879	12.23	13.24	8.3	8.3	/	/	508	5.0	200	0.002	<0.01
002	B	BUS - PERIMETER DEPUT FENCE CAR PARK (B)	0657	0865	12.23	13.24	8.3	8.3	/	/	506	4.5	200	0.002	<0.01
003	B	VISION PERIMETER LABS - CAR PARK (C)	0150	0778	12.33	13.34	8.3	8.3	/	/	506	3.5	200	0.002	<0.01
004	B	VISION - PERIMETER LABS - CAR PARK (D)	0159	0873	12.33	13.34	8.3	8.3	/	/	506	3.5	200	0.002	<0.01
005	B	WFCM EXTERNAL BID SCALING AREA (E)	0836	0878	12.44	13.44	8.3	8.3	/	/	498	1.5	200	0.001	<0.01
006	B	WFCM PERIMETER BID - CAR PARK (F)	0150	0878	13.40	14.46	8.3	8.3	/	/	498	3.0	200	0.001	<0.01
007	B	WFCM REAR OT HOUSING - CAR PARK (G)	0427	0865	13.53	14.53	8.3	8.3	/	/	498	4.0	200	0.002	<0.01
008	B	WFCM - REAR GOLF HOUSING - CAR PARK (H)	0656	0879	13.53	14.53	8.3	8.3	/	/	498	2.0	200	0.001	<0.01
009	B	REAR GOLF PRINT - CAR PARK (I)	0159	0738	14.05	15.05	8.3	8.3	/	/	498	3.0	200	0.001	<0.01
010	B	SITE (AB) COUNCIL OFFICE (J)	0150	0854	14.25	15.25	8.3	8.3	/	/	498	3.5	200	0.002	<0.01



AIRBORNE FIBRE SAMPLING & ANALYSIS CERTIFICATE (Part 2)

1089

Client:

Wyre Forest District Council

Report No:

1334

Page No:

2

of:

2

Address:

WFOC, Wyre Forest House, Firepoint Way

Site Address:

Lawrenes Recycling, Staveport Rd, Ox12 2RE

KEY: ENCLOSURE = N/A

AIR MOVER = N/A

HYGIENE UNIT = N/A

SAMPLE POM = (X)

Sampling and analysis carried out following internal procedures SCI/ASB/005 Procedure for airborne fibre sampling and SCI/ASB/006 Procedure for airborne fibre counting based on the main procedural point of HSE document HSG248 The analysts guide for sampling analysis and clearance procedures The opinions and interpretations indicated are outside the scope of UKAS accreditation.

COMMENTS: Background Air Monitoring During Demolition of Lawrenes Recycling To establish airborne fibre levels to various local Businesses

CLEARANCE DETAILS

Enclosure Area: m² Enclosure Volume: m³

Enclosure Intact? N A Enclosure Dry? min

Dust Disturbance Method: A Dust Disturbance Duration: min

Number of Tests Required: Asbestos Type:

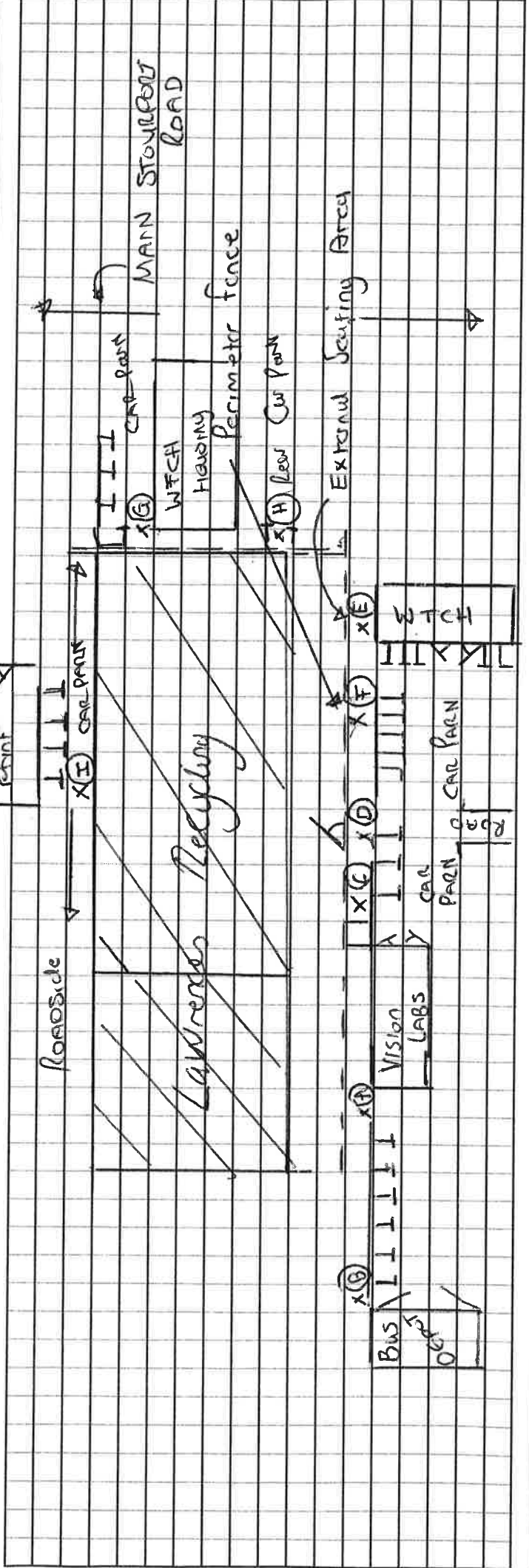

Contractor Signature:

N/A

Analyst Signature: